

# CONCEPTUAL DESIGN EXHIBIT NOT FOR CONSTRUCTION

DISTRICT	COUNTY	ROUTE	SECTION	SHEET
6-0	CHESTER	TWP	-	1 OF 8
KENNETT TOWNSHIP				
REVISION NUMBER	REVISIONS	DATE	BY	

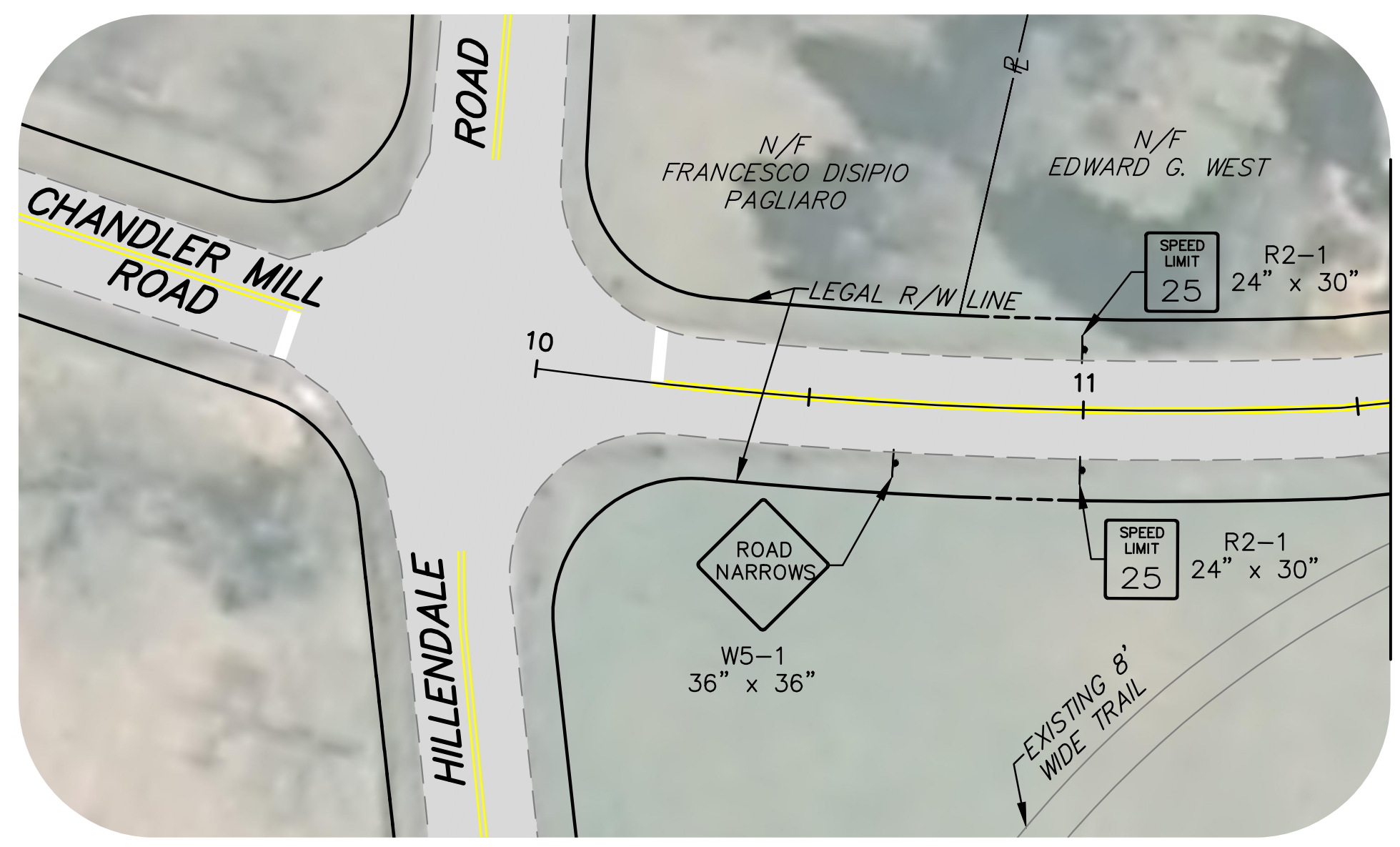

MATCHLINE A-A  
SEE BELOW

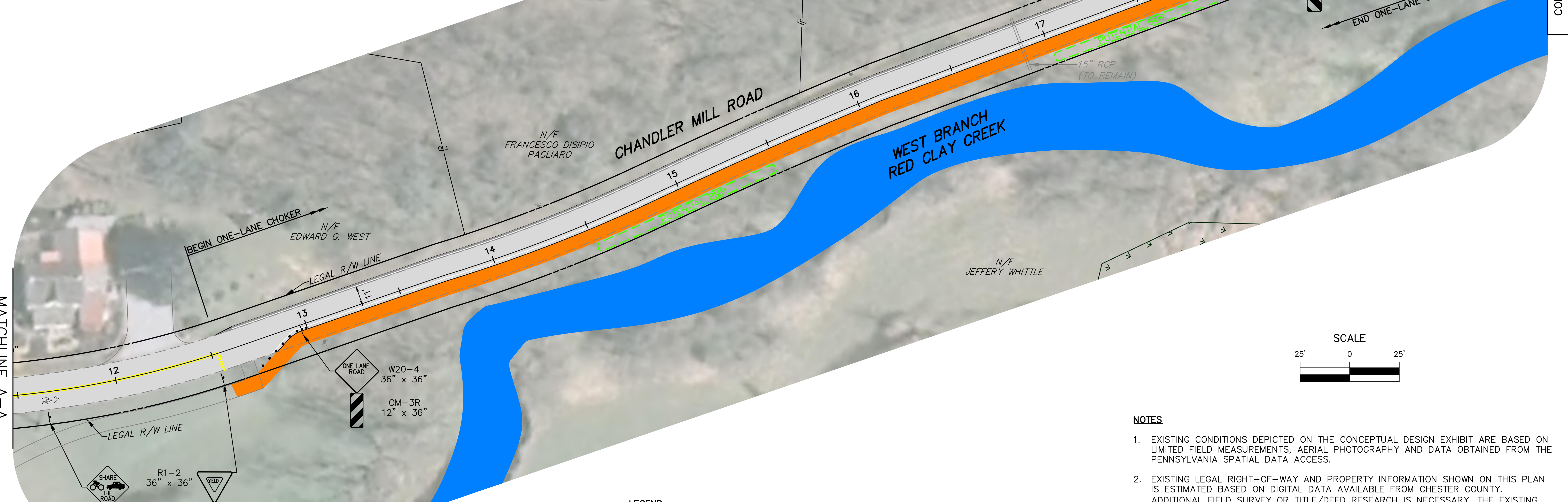
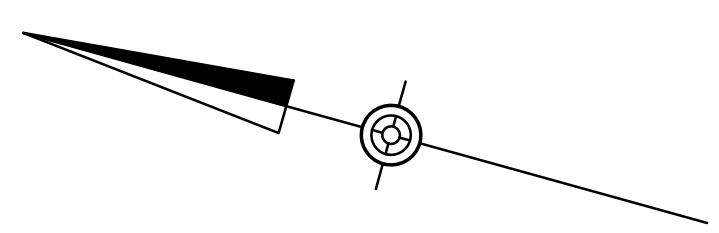

MATCHLINE A-A  
SEE ABOVE

CONTINUED ON SHEET 2

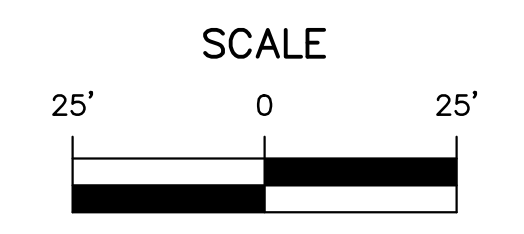

<b>LEGEND</b>	
STONEDUST PEDESTRIAN TRAIL, 8' WIDE	NEW PAVEMENT
WETLANDS (APPROX.)	ELEVATED BOARDWALK
EXISTING RIGHT-OF-WAY LINE	EXISTING PROPERTY LINE
NEW PAVEMENT MARKINGS	ASPHALT PAVEMENT AND PAINTED CROSSWALK AT DRIVEWAY CROSSING

**NOTES**

- EXISTING CONDITIONS DEPICTED ON THE CONCEPTUAL DESIGN EXHIBIT ARE BASED ON LIMITED FIELD MEASUREMENTS, AERIAL PHOTOGRAPHY AND DATA OBTAINED FROM THE PENNSYLVANIA SPATIAL DATA ACCESS.
- EXISTING LEGAL RIGHT-OF-WAY AND PROPERTY INFORMATION SHOWN ON THIS PLAN IS ESTIMATED BASED ON DIGITAL DATA AVAILABLE FROM CHESTER COUNTY. ADDITIONAL FIELD SURVEY OR TITLE/DEED RESEARCH IS NECESSARY. THE EXISTING LEGAL RIGHT-OF-WAY WAS DRAWN BY OFFSETTING THE CENTERLINE OF THE ROADWAY 16.5' ON EITHER SIDE
- WETLAND AREAS DEPICTED ON THE CONCEPTUAL DESIGN EXHIBIT ARE BASED ON DIGITAL DATA OBTAINED FROM THE U.S. FISH AND WILDLIFE SERVICE.
- TEMPORARY CONSTRUCTION EASEMENTS REQUIRED TO INSTALL TRAIL AND PERMANENT DRAINAGE EASEMENTS TO REQUIRED TO EXTEND PIPES ARE NOT SHOWN. THE SIZE AND LOCATION OF REQUIRED TEMPORARY CONSTRUCTION EASEMENTS WILL BE DETERMINED DURING THE PRELIMINARY ENGINEERING OF THE PROJECT.
- POTENTIAL BEST MANAGEMENT PRACTICES (BMP) AREAS MARKED HAVE NOT BEEN DESIGNED OR SIZED. EXACT BMP TYPE AND SIZE WILL BE DETERMINED DURING PRELIMINARY ENGINEERING AND THROUGH COORDINATION WITH THE CHESTER COUNTY CONSERVATION DISTRICT AND THE PA DEP.

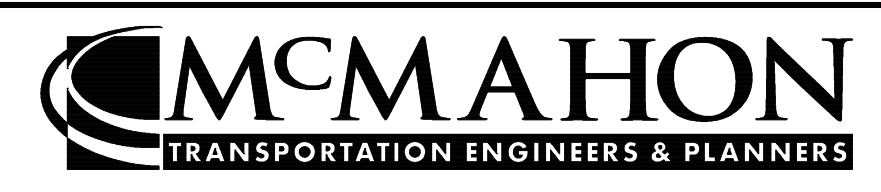

425 COMMERCE DR  
SUITE 200  
FT WASHINGTON, PA. 19034  
TELE: (215)-283-9444  
FAX: (215)-283-9447

840 SPRINGDALE DR  
EXTON, PA. 19341  
TELE: (610)-594-9995  
FAX: (610)-594-9565

3903 HARTZDALE DRIVE  
SUITE 301  
CAMP HILL, PA. 17011  
TELE: (717)-975-0295  
FAX: (717)-975-0294

DESIGN BY: KDK  
DRAWN BY: JCT  
CHECKED BY: JJK  
JOB NO: 815296  
DWG: 296CPT01  
DATE: 07/10/15

**KENNETT TOWNSHIP**  
841 BURROWS RUN ROAD  
CHADDS FORD, PA 19317  
(610)-388-1300

**RED CLAY GREENWAY TRAIL AND TRAFFIC CALMING IMPROVEMENTS ALONG CHANDLER MILL ROAD**  
KENNETT TOWNSHIP  
CHESTER COUNTY

# CONCEPTUAL DESIGN EXHIBIT NOT FOR CONSTRUCTION

DISTRICT	COUNTY	ROUTE	SECTION	SHEET
6-0	CHESTER	TWP	-	2 OF 8
KENNETT TOWNSHIP				
REVISION NUMBER	REVISIONS			DATE

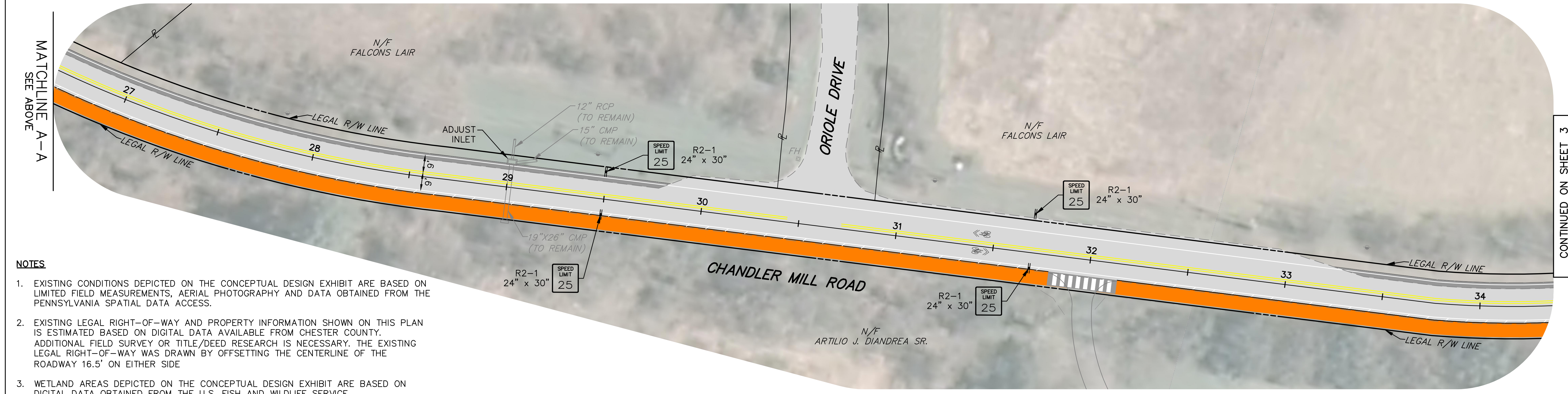
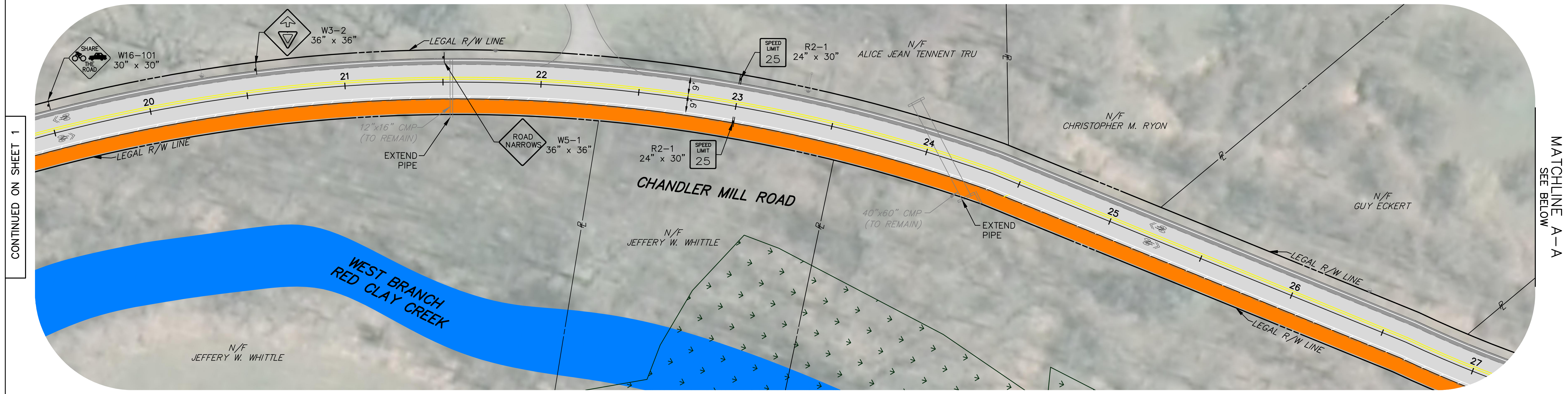
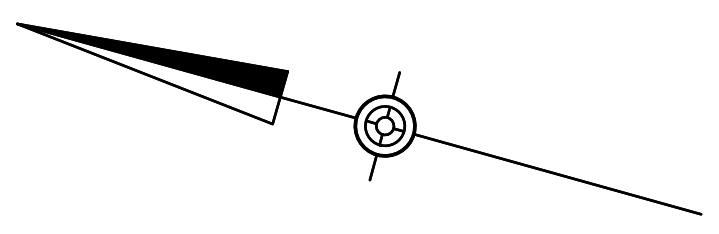
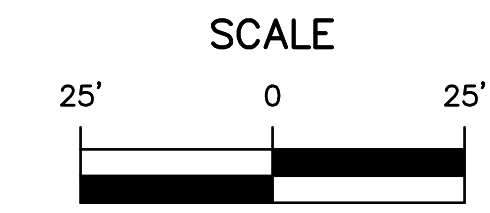

- NOTES**
- EXISTING CONDITIONS DEPICTED ON THE CONCEPTUAL DESIGN EXHIBIT ARE BASED ON LIMITED FIELD MEASUREMENTS, AERIAL PHOTOGRAPHY AND DATA OBTAINED FROM THE PENNSYLVANIA SPATIAL DATA ACCESS.
  - EXISTING LEGAL RIGHT-OF-WAY AND PROPERTY INFORMATION SHOWN ON THIS PLAN IS ESTIMATED BASED ON DIGITAL DATA AVAILABLE FROM CHESTER COUNTY. ADDITIONAL FIELD SURVEY OR TITLE/DEED RESEARCH IS NECESSARY. THE EXISTING LEGAL RIGHT-OF-WAY WAS DRAWN BY OFFSETTING THE CENTERLINE OF THE ROADWAY 16.5' ON EITHER SIDE
  - WETLAND AREAS DEPICTED ON THE CONCEPTUAL DESIGN EXHIBIT ARE BASED ON DIGITAL DATA OBTAINED FROM THE U.S. FISH AND WILDLIFE SERVICE.
  - TEMPORARY CONSTRUCTION EASEMENTS REQUIRED TO INSTALL TRAIL AND PERMANENT DRAINAGE EASEMENTS TO REQUIRED TO EXTEND PIPES ARE NOT SHOWN. THE SIZE AND LOCATION OF REQUIRED TEMPORARY CONSTRUCTION EASEMENTS WILL BE DETERMINED DURING THE PRELIMINARY ENGINEERING OF THE PROJECT.
  - POTENTIAL BEST MANAGEMENT PRACTICES (BMP) AREAS MARKED HAVE NOT BEEN DESIGNED OR SIZED. EXACT BMP TYPE AND SIZE WILL BE DETERMINED DURING PRELIMINARY ENGINEERING AND THROUGH COORDINATION WITH THE CHESTER COUNTY CONSERVATION DISTRICT AND THE PA DEP.

<b>LEGEND</b>	STONEDUST PEDESTRIAN TRAIL, 8' WIDE WETLANDS (APPROX.)	NEW PAVEMENT BOARDWALK AREA	EXISTING RIGHT-OF-WAY LINE NEW PAVEMENT MARKINGS	EXISTING PROPERTY LINE ASPHALT PAVEMENT AND PAINTED CROSSWALK AT DRIVEWAY CROSSING
---------------	---	--------------------------------	---	---

	425 COMMERCE DR SUITE 200 FT WASHINGTON, PA. 19034 TELE: (215)-283-9444 FAX: (215)-283-9447	840 SPRINGDALE DR EXTON, PA. 19341 TELE: (610)-594-9995 FAX: (610)-594-9565	3903 HARTZDALE DRIVE SUITE 301 CAMP HILL, PA. 17011 TELE: (717)-975-0295 FAX: (717)-975-0294	DESIGN BY: KDK DRAWN BY: JCT CHECKED BY: JJK	JOB NO: 815296 DWG: 296CPT02 DATE: 07/10/15	<b>KENNETT TOWNSHIP</b> 841 BURROWS RUN ROAD CHADDS FORD, PA 19317 (610)-388-1300	<b>RED CLAY GREENWAY TRAIL AND TRAFFIC CALMING IMPROVEMENTS ALONG CHANDLER MILL ROAD</b> KENNETT TOWNSHIP CHESTER COUNTY
--	---	--	--	--	---	--	--

# CONCEPTUAL DESIGN EXHIBIT NOT FOR CONSTRUCTION

DISTRICT	COUNTY	ROUTE	SECTION	SHEET
6-0	CHESTER	TWP	-	3 OF 8
KENNETT TOWNSHIP				
REVISION NUMBER	REVISIONS			DATE

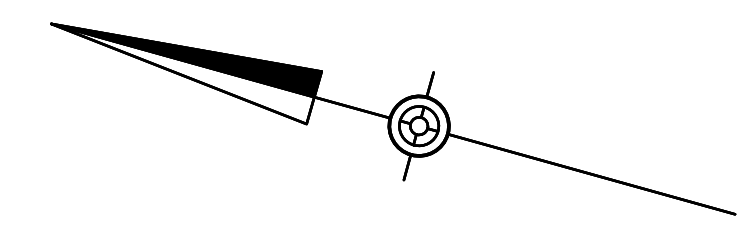
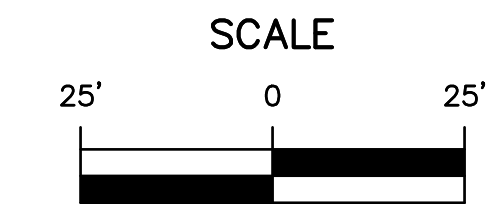

CONTINUED ON SHEET 2

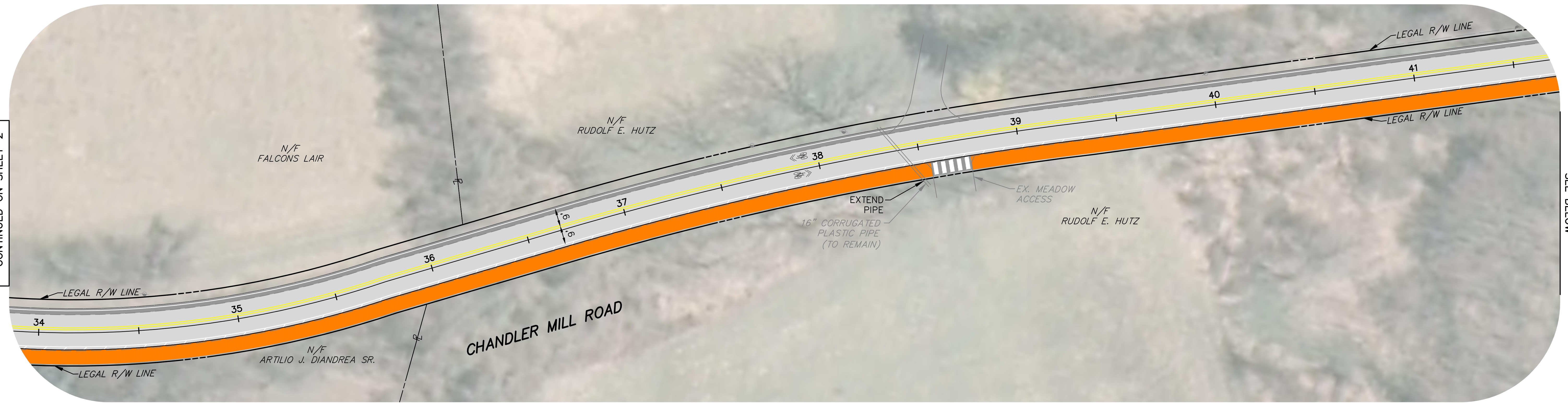

MATCHLINE A-A  
SEE BELOW

MATCHLINE A-A  
SEE ABOVE

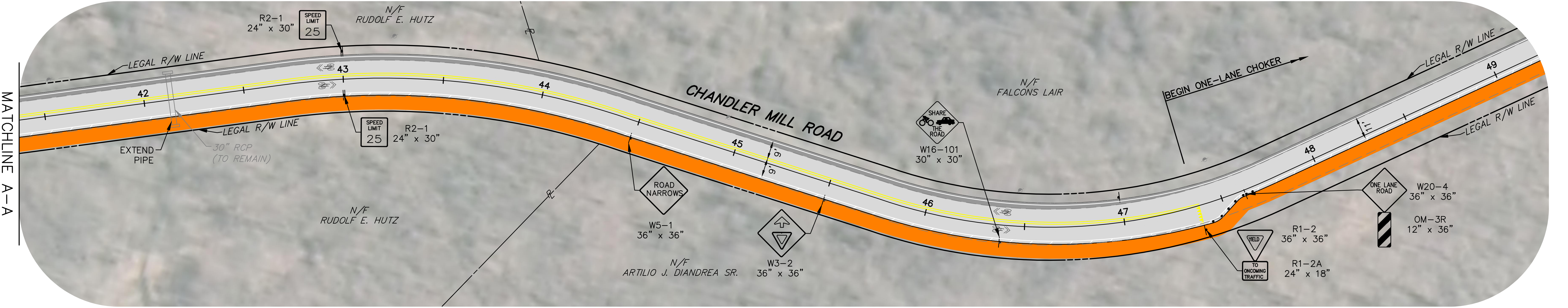

SHEET NO. 4  
CONTINUED

**NOTES**

1. EXISTING CONDITIONS DEPICTED ON THE CONCEPTUAL DESIGN EXHIBIT ARE BASED ON LIMITED FIELD MEASUREMENTS, AERIAL PHOTOGRAPHY AND DATA OBTAINED FROM THE PENNSYLVANIA SPATIAL DATA ACCESS.
2. EXISTING LEGAL RIGHT-OF-WAY AND PROPERTY INFORMATION SHOWN ON THIS PLAN IS ESTIMATED BASED ON DIGITAL DATA AVAILABLE FROM CHESTER COUNTY. ADDITIONAL FIELD SURVEY OR TITLE/DEED RESEARCH IS NECESSARY. THE EXISTING LEGAL RIGHT-OF-WAY WAS DRAWN BY OFFSETTING THE CENTERLINE OF THE ROADWAY 16.5' ON EITHER SIDE
3. WETLAND AREAS DEPICTED ON THE CONCEPTUAL DESIGN EXHIBIT ARE BASED ON DIGITAL DATA OBTAINED FROM THE U.S. FISH AND WILDLIFE SERVICE.
4. TEMPORARY CONSTRUCTION EASEMENTS REQUIRED TO INSTALL TRAIL AND PERMANENT DRAINAGE EASEMENTS TO REQUIRED TO EXTEND PIPES ARE NOT SHOWN. THE SIZE AND LOCATION OF REQUIRED TEMPORARY CONSTRUCTION EASEMENTS WILL BE DETERMINED DURING THE PRELIMINARY ENGINEERING OF THE PROJECT.
5. POTENTIAL BEST MANAGEMENT PRACTICES (BMP) AREAS MARKED HAVE NOT BEEN DESIGNED OR SIZED. EXACT BMP TYPE AND SIZE WILL BE DETERMINED DURING PRELIMINARY ENGINEERING AND THROUGH COORDINATION WITH THE CHESTER COUNTY CONSERVATION DISTRICT AND THE PA DEP.

**LEGEND**

- |  |                                     |  |   |
|--|-------------------------------------|--|---|
|  | STONEDUST PEDESTRIAN TRAIL, 8' WIDE |  | NEW PAVEMENT  |
|  | WETLANDS (APPROX.)                  |  | BOARDWALK AREA  |
|  | EXISTING RIGHT-OF-WAY LINE          |  | EXISTING PROPERTY LINE                                      |
|  | NEW PAVEMENT MARKINGS               |  | ASPHALT PAVEMENT AND PAINTED CROSSWALK AT DRIVEWAY CROSSING |

**MCM MAHON**  
TRANSPORTATION ENGINEERS & PLANNERS

425 COMMERCE DR  
SUITE 200  
FT WASHINGTON, PA. 19034  
TELE: (215)-283-9444  
FAX: (215)-283-9447

840 SPRINGDALE DR  
EXTON, PA. 19341  
TELE: (610)-594-9995  
FAX: (610)-594-9565

3903 HARTZDALE DRIVE  
SUITE 301  
CAMP HILL, PA. 17011  
TELE: (717)-975-0295  
FAX: (717)-975-0294

DESIGN BY: KDK  
DRAWN BY: JCT  
CHECKED BY: JJK  
JOB NO: 815296  
DWG: 296CPT03  
DATE: 07/10/15

**KENNETT TOWNSHIP**  
841 BURROWS RUN ROAD  
CHADDS FORD, PA 19317  
(610)-388-1300

**RED CLAY GREENWAY TRAIL AND TRAFFIC CALMING  
IMPROVEMENTS ALONG CHANDLER MILL ROAD**  
KENNETT TOWNSHIP      CHESTER COUNTY

# CONCEPTUAL DESIGN EXHIBIT NOT FOR CONSTRUCTION

DISTRICT	COUNTY	ROUTE	SECTION	SHEET
6-0	CHESTER	TWP	-	4 OF 8
KENNETT TOWNSHIP				
REVISION NUMBER	REVISIONS	DATE	BY	

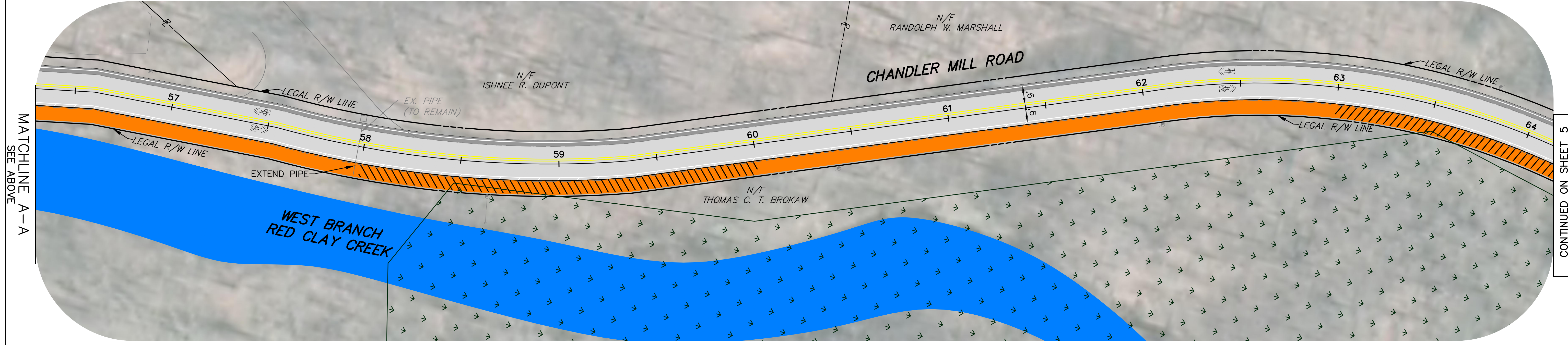
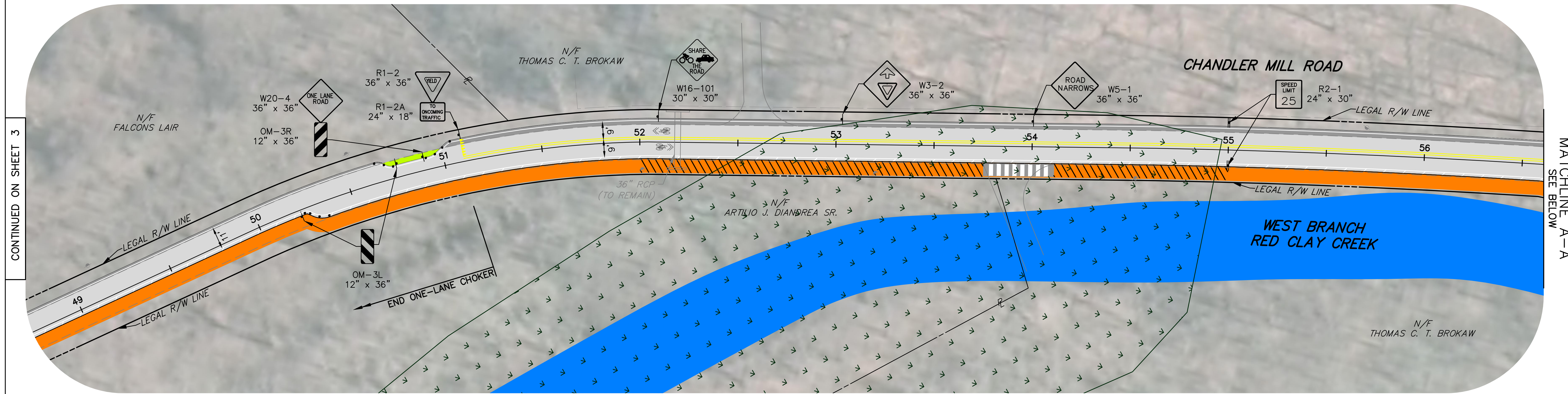
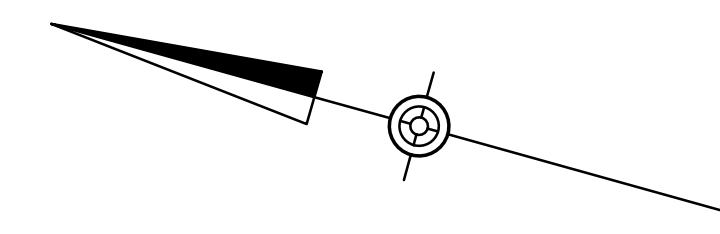
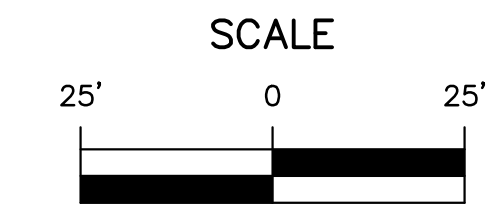

- NOTES**
- EXISTING CONDITIONS DEPICTED ON THE CONCEPTUAL DESIGN EXHIBIT ARE BASED ON LIMITED FIELD MEASUREMENTS, AERIAL PHOTOGRAPHY AND DATA OBTAINED FROM THE PENNSYLVANIA SPATIAL DATA ACCESS.
  - EXISTING LEGAL RIGHT-OF-WAY AND PROPERTY INFORMATION SHOWN ON THIS PLAN IS ESTIMATED BASED ON DIGITAL DATA AVAILABLE FROM CHESTER COUNTY. ADDITIONAL FIELD SURVEY OR TITLE/DEED RESEARCH IS NECESSARY. THE EXISTING LEGAL RIGHT-OF-WAY WAS DRAWN BY OFFSETTING THE CENTERLINE OF THE ROADWAY 16.5' ON EITHER SIDE
  - WETLAND AREAS DEPICTED ON THE CONCEPTUAL DESIGN EXHIBIT ARE BASED ON DIGITAL DATA OBTAINED FROM THE U.S. FISH AND WILDLIFE SERVICE.
  - TEMPORARY CONSTRUCTION EASEMENTS REQUIRED TO INSTALL TRAIL AND PERMANENT DRAINAGE EASEMENTS TO REQUIRED TO EXTEND PIPES ARE NOT SHOWN. THE SIZE AND LOCATION OF REQUIRED TEMPORARY CONSTRUCTION EASEMENTS WILL BE DETERMINED DURING THE PRELIMINARY ENGINEERING OF THE PROJECT.
  - POTENTIAL BEST MANAGEMENT PRACTICES (BMP) AREAS MARKED HAVE NOT BEEN DESIGNED OR SIZED. EXACT BMP TYPE AND SIZE WILL BE DETERMINED DURING PRELIMINARY ENGINEERING AND THROUGH COORDINATION WITH THE CHESTER COUNTY CONSERVATION DISTRICT AND THE PA DEP.

**LEGEND**

STONEDUST PEDESTRIAN TRAIL, 8' WIDE	NEW PAVEMENT
WETLANDS (APPROX.)	BOARDWALK AREA
EXISTING RIGHT-OF-WAY LINE	EXISTING PROPERTY LINE
NEW PAVEMENT MARKINGS	ASPHALT PAVEMENT AND PAINTED CROSSWALK AT DRIVEWAY CROSSING

425 COMMERCE DR  
SUITE 200  
FT WASHINGTON, PA. 19034  
TELE: (215)-283-9444  
FAX: (215)-283-9447

840 SPRINGDALE DR  
EXTON, PA. 19341  
TELE: (610)-594-9995  
FAX: (610)-594-9565

3903 HARTZDALE DRIVE  
SUITE 301  
CAMP HILL, PA. 17011  
TELE: (717)-975-0295  
FAX: (717)-975-0294

DESIGN BY: KDK  
DRAWN BY: JCT  
CHECKED BY: JJK  
JOB NO: 815296  
DWG: 296CPT04  
DATE: 07/10/15

**KENNETT TOWNSHIP**  
841 BURROWS RUN ROAD  
CHADDS FORD, PA 19317  
(610)-388-1300

**RED CLAY GREENWAY TRAIL AND TRAFFIC CALMING  
IMPROVEMENTS ALONG CHANDLER MILL ROAD**  
KENNETT TOWNSHIP      CHESTER COUNTY

DISTRICT	COUNTY	ROUTE	SECTION	SHEET
6-0	CHESTER	TWP	-	5 OF 8
KENNETT TOWNSHIP				
REVISION NUMBER	REVISIONS	DATE	BY	

**CONCEPTUAL DESIGN EXHIBIT  
NOT FOR CONSTRUCTION**

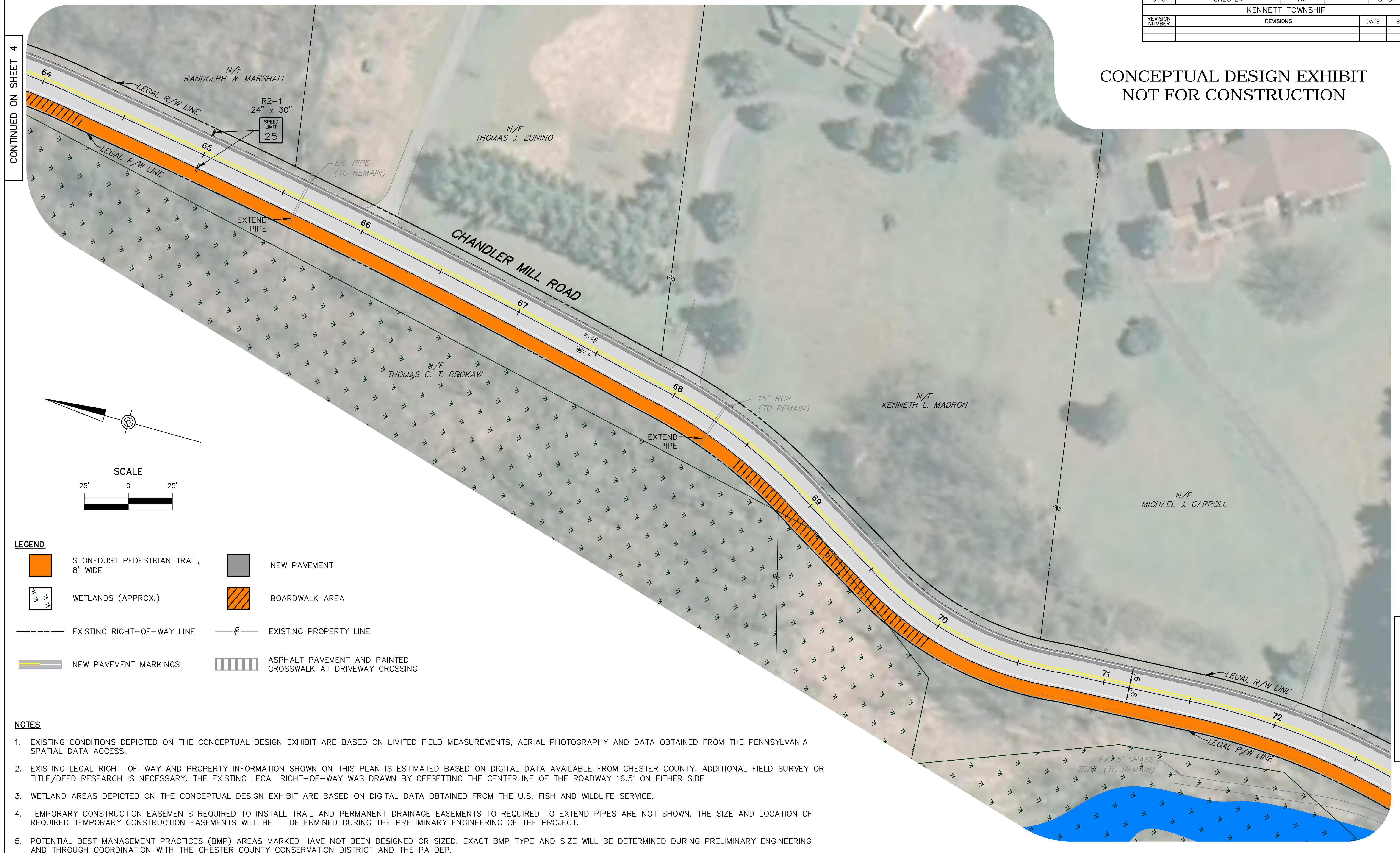

CONTINUED ON SHEET 4

CONTINUED ON SHEET 6

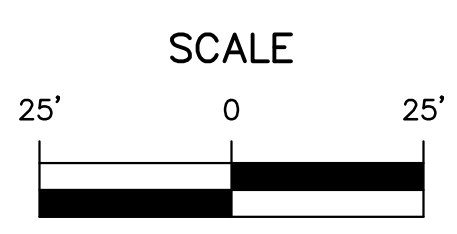
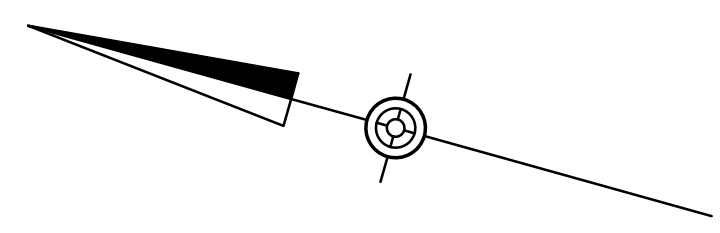

**LEGEND**

	STONEDUST PEDESTRIAN TRAIL, 8' WIDE		NEW PAVEMENT
	WETLANDS (APPROX.)		BOARDWALK AREA
	EXISTING RIGHT-OF-WAY LINE		EXISTING PROPERTY LINE
	NEW PAVEMENT MARKINGS		ASPHALT PAVEMENT AND PAINTED CROSSWALK AT DRIVEWAY CROSSING

**NOTES**

1. EXISTING CONDITIONS DEPICTED ON THE CONCEPTUAL DESIGN EXHIBIT ARE BASED ON LIMITED FIELD MEASUREMENTS, AERIAL PHOTOGRAPHY AND DATA OBTAINED FROM THE PENNSYLVANIA SPATIAL DATA ACCESS.
2. EXISTING LEGAL RIGHT-OF-WAY AND PROPERTY INFORMATION SHOWN ON THIS PLAN IS ESTIMATED BASED ON DIGITAL DATA AVAILABLE FROM CHESTER COUNTY. ADDITIONAL FIELD SURVEY OR TITLE/DEED RESEARCH IS NECESSARY. THE EXISTING LEGAL RIGHT-OF-WAY WAS DRAWN BY OFFSETTING THE CENTERLINE OF THE ROADWAY 16.5' ON EITHER SIDE
3. WETLAND AREAS DEPICTED ON THE CONCEPTUAL DESIGN EXHIBIT ARE BASED ON DIGITAL DATA OBTAINED FROM THE U.S. FISH AND WILDLIFE SERVICE.
4. TEMPORARY CONSTRUCTION EASEMENTS REQUIRED TO INSTALL TRAIL AND PERMANENT DRAINAGE EASEMENTS TO REQUIRED TO EXTEND PIPES ARE NOT SHOWN. THE SIZE AND LOCATION OF REQUIRED TEMPORARY CONSTRUCTION EASEMENTS WILL BE DETERMINED DURING THE PRELIMINARY ENGINEERING OF THE PROJECT.
5. POTENTIAL BEST MANAGEMENT PRACTICES (BMP) AREAS MARKED HAVE NOT BEEN DESIGNED OR SIZED. EXACT BMP TYPE AND SIZE WILL BE DETERMINED DURING PRELIMINARY ENGINEERING AND THROUGH COORDINATION WITH THE CHESTER COUNTY CONSERVATION DISTRICT AND THE PA DEP.

**MCM MAHON**  
TRANSPORTATION ENGINEERS & PLANNERS

425 COMMERCE DR  
SUITE 200  
FT WASHINGTON, PA. 19034  
TELE: (215)-283-9444  
FAX: (215)-283-9447

840 SPRINGDALE DR  
EXTON, PA. 19341  
TELE: (610)-594-9995  
FAX: (610)-594-9565

3903 HARTZDALE DRIVE  
SUITE 301  
CAMP HILL, PA. 17011  
TELE: (717)-975-0295  
FAX: (717)-975-0294

DESIGN BY: KDK  
DRAWN BY: JCT  
CHECKED BY: JJK  
JOB NO: 815296  
DWG: 296CPT05  
DATE: 07/10/15







**KENNETT TOWNSHIP**  
841 BURROWS RUN ROAD  
CHADDS FORD, PA 19317  
(610)-388-1300

**RED CLAY GREENWAY TRAIL AND TRAFFIC CALMING IMPROVEMENTS ALONG CHANDLER MILL ROAD**  
KENNETT TOWNSHIP  
CHESTER COUNTY

DISTRICT	COUNTY	ROUTE	SECTION	SHEET
6-0	CHESTER	TWP	-	6 OF 8
KENNETT TOWNSHIP				
REVISION NUMBER	REVISIONS	DATE	BY	

## CONCEPTUAL DESIGN EXHIBIT NOT FOR CONSTRUCTION

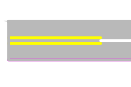
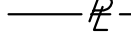
**LEGEND**

	STONEDUST PEDESTRIAN TRAIL, 8' WIDE		NEW PAVEMENT
	WETLANDS (APPROX.)		BOARDWALK AREA
	EXISTING RIGHT-OF-WAY LINE		
	NEW PAVEMENT MARKINGS		
	EXISTING PROPERTY LINE		
	ASPHALT PAVEMENT AND PAINTED CROSSWALK AT DRIVEWAY CROSSING		

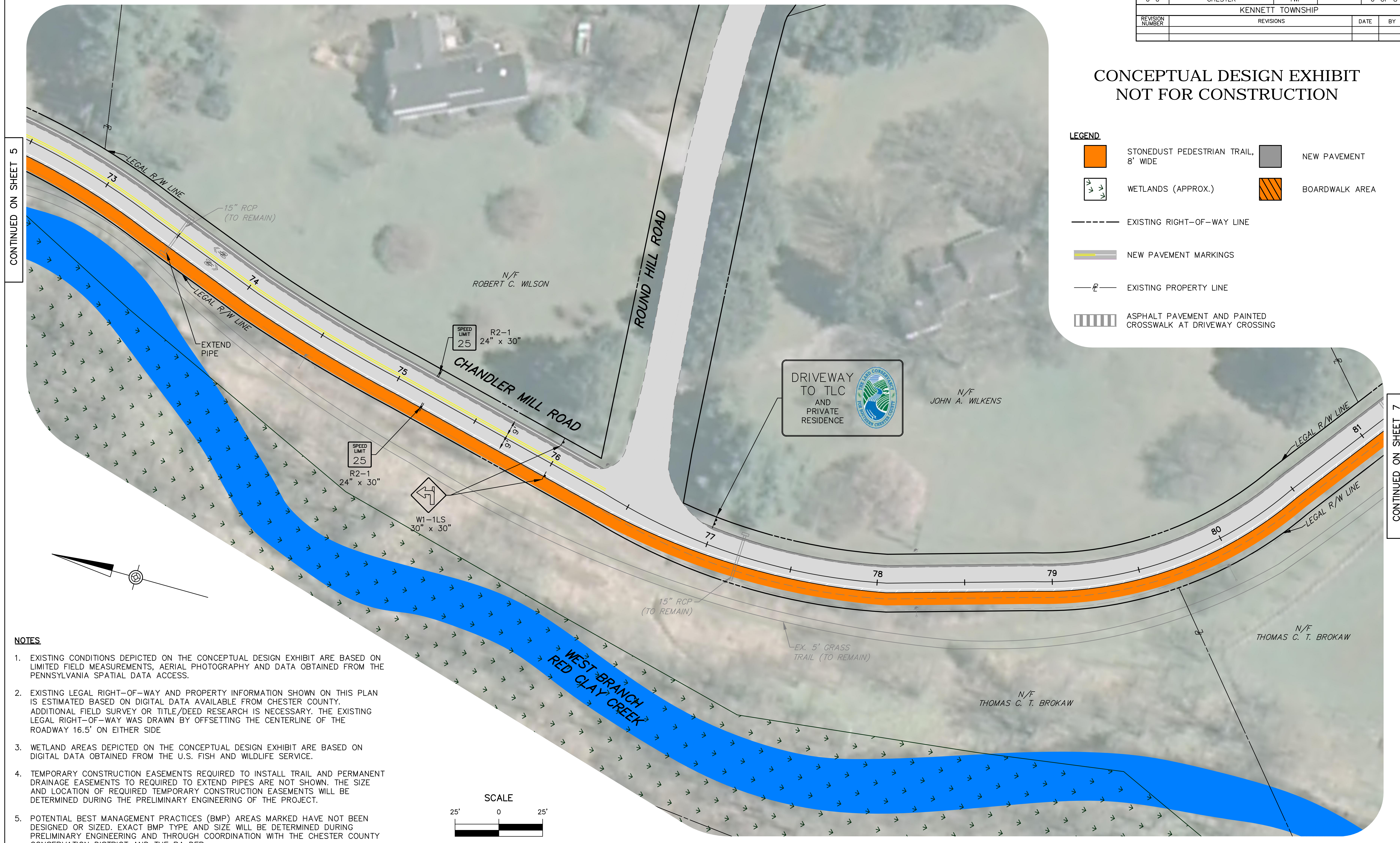

CONTINUED ON SHEET 5

CONTINUED ON SHEET 7

- NOTES**
- EXISTING CONDITIONS DEPICTED ON THE CONCEPTUAL DESIGN EXHIBIT ARE BASED ON LIMITED FIELD MEASUREMENTS, AERIAL PHOTOGRAPHY AND DATA OBTAINED FROM THE PENNSYLVANIA SPATIAL DATA ACCESS.
  - EXISTING LEGAL RIGHT-OF-WAY AND PROPERTY INFORMATION SHOWN ON THIS PLAN IS ESTIMATED BASED ON DIGITAL DATA AVAILABLE FROM CHESTER COUNTY. ADDITIONAL FIELD SURVEY OR TITLE/DEED RESEARCH IS NECESSARY. THE EXISTING LEGAL RIGHT-OF-WAY WAS DRAWN BY OFFSETTING THE CENTERLINE OF THE ROADWAY 16.5' ON EITHER SIDE
  - WETLAND AREAS DEPICTED ON THE CONCEPTUAL DESIGN EXHIBIT ARE BASED ON DIGITAL DATA OBTAINED FROM THE U.S. FISH AND WILDLIFE SERVICE.
  - TEMPORARY CONSTRUCTION EASEMENTS REQUIRED TO INSTALL TRAIL AND PERMANENT DRAINAGE EASEMENTS TO REQUIRED TO EXTEND PIPES ARE NOT SHOWN. THE SIZE AND LOCATION OF REQUIRED TEMPORARY CONSTRUCTION EASEMENTS WILL BE DETERMINED DURING THE PRELIMINARY ENGINEERING OF THE PROJECT.
  - POTENTIAL BEST MANAGEMENT PRACTICES (BMP) AREAS MARKED HAVE NOT BEEN DESIGNED OR SIZED. EXACT BMP TYPE AND SIZE WILL BE DETERMINED DURING PRELIMINARY ENGINEERING AND THROUGH COORDINATION WITH THE CHESTER COUNTY CONSERVATION DISTRICT AND THE PA DEP.

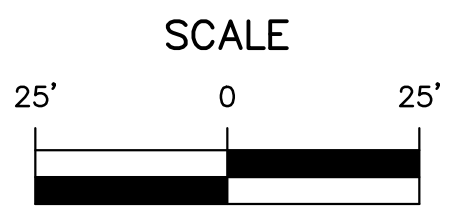

**MCM MAHON**  
TRANSPORTATION ENGINEERS & PLANNERS

425 COMMERCE DR  
SUITE 200  
FT WASHINGTON, PA. 19034  
TELE: (215)-283-9444  
FAX: (215)-283-9447

840 SPRINGDALE DR  
EXTON, PA. 19341  
TELE: (610)-594-9995  
FAX: (610)-594-9565

3903 HARTZDALE DRIVE  
SUITE 301  
CAMP HILL, PA. 17011  
TELE: (717)-975-0295  
FAX: (717)-975-0294

DESIGN BY: KDK  
DRAWN BY: JCT  
CHECKED BY: JJK  
JOB NO: 815296  
DWG: 296CPT06  
DATE: 07/10/15









**KENNETT TOWNSHIP**  
841 BURROWS RUN ROAD  
CHADDS FORD, PA 19317  
(610)-388-1300

**RED CLAY GREENWAY TRAIL AND TRAFFIC CALMING IMPROVEMENTS ALONG CHANDLER MILL ROAD**  
KENNETT TOWNSHIP  
CHESTER COUNTY

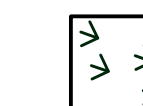
**NOTES**

- EXISTING CONDITIONS DEPICTED ON THE CONCEPTUAL DESIGN EXHIBIT ARE BASED ON LIMITED FIELD MEASUREMENTS, AERIAL PHOTOGRAPHY AND DATA OBTAINED FROM THE PENNSYLVANIA SPATIAL DATA ACCESS.
- EXISTING LEGAL RIGHT-OF-WAY AND PROPERTY INFORMATION SHOWN ON THIS PLAN IS ESTIMATED BASED ON DIGITAL DATA AVAILABLE FROM CHESTER COUNTY. ADDITIONAL FIELD SURVEY OR TITLE/DEED RESEARCH IS NECESSARY. THE EXISTING LEGAL RIGHT-OF-WAY WAS DRAWN BY OFFSETTING THE CENTERLINE OF THE ROADWAY 16.5' ON EITHER SIDE
- WETLAND AREAS DEPICTED ON THE CONCEPTUAL DESIGN EXHIBIT ARE BASED ON DIGITAL DATA OBTAINED FROM THE U.S. FISH AND WILDLIFE SERVICE.
- TEMPORARY CONSTRUCTION EASEMENTS REQUIRED TO INSTALL TRAIL AND PERMANENT DRAINAGE EASEMENTS TO REQUIRED TO EXTEND PIPES ARE NOT SHOWN. THE SIZE AND LOCATION OF REQUIRED TEMPORARY CONSTRUCTION EASEMENTS WILL BE DETERMINED DURING THE PRELIMINARY ENGINEERING OF THE PROJECT.
- POTENTIAL BEST MANAGEMENT PRACTICES (BMP) AREAS MARKED HAVE NOT BEEN DESIGNED OR SIZED. EXACT BMP TYPE AND SIZE WILL BE DETERMINED DURING PRELIMINARY ENGINEERING AND THROUGH COORDINATION WITH THE CHESTER COUNTY CONSERVATION DISTRICT AND THE PA DEP.

**LEGEND**

-  STONEDUST PEDESTRIAN TRAIL, 8' WIDE
-  NEW PAVEMENT
-  WETLANDS (APPROX.)
-  BOARDWALK AREA
-  EXISTING RIGHT-OF-WAY LINE
-  NEW PAVEMENT MARKINGS
-  EXISTING PROPERTY LINE
-  ASPHALT PAVEMENT AND PAINTED CROSSWALK AT DRIVEWAY CROSSING

DISTRICT	COUNTY	ROUTE	SECTION	SHEET
6-0	CHESTER	TWP	-	7 OF 8
KENNETT TOWNSHIP				
REVISION NUMBER	REVISIONS	DATE	BY	

CONTINUED ON SHEET 6

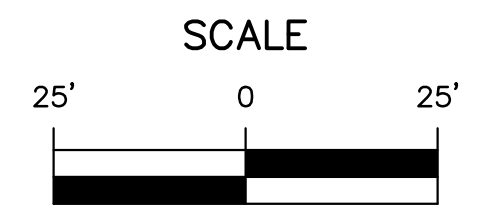
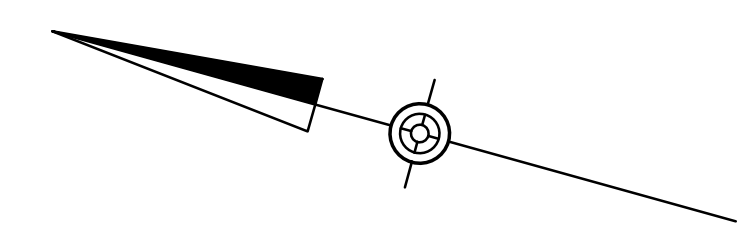
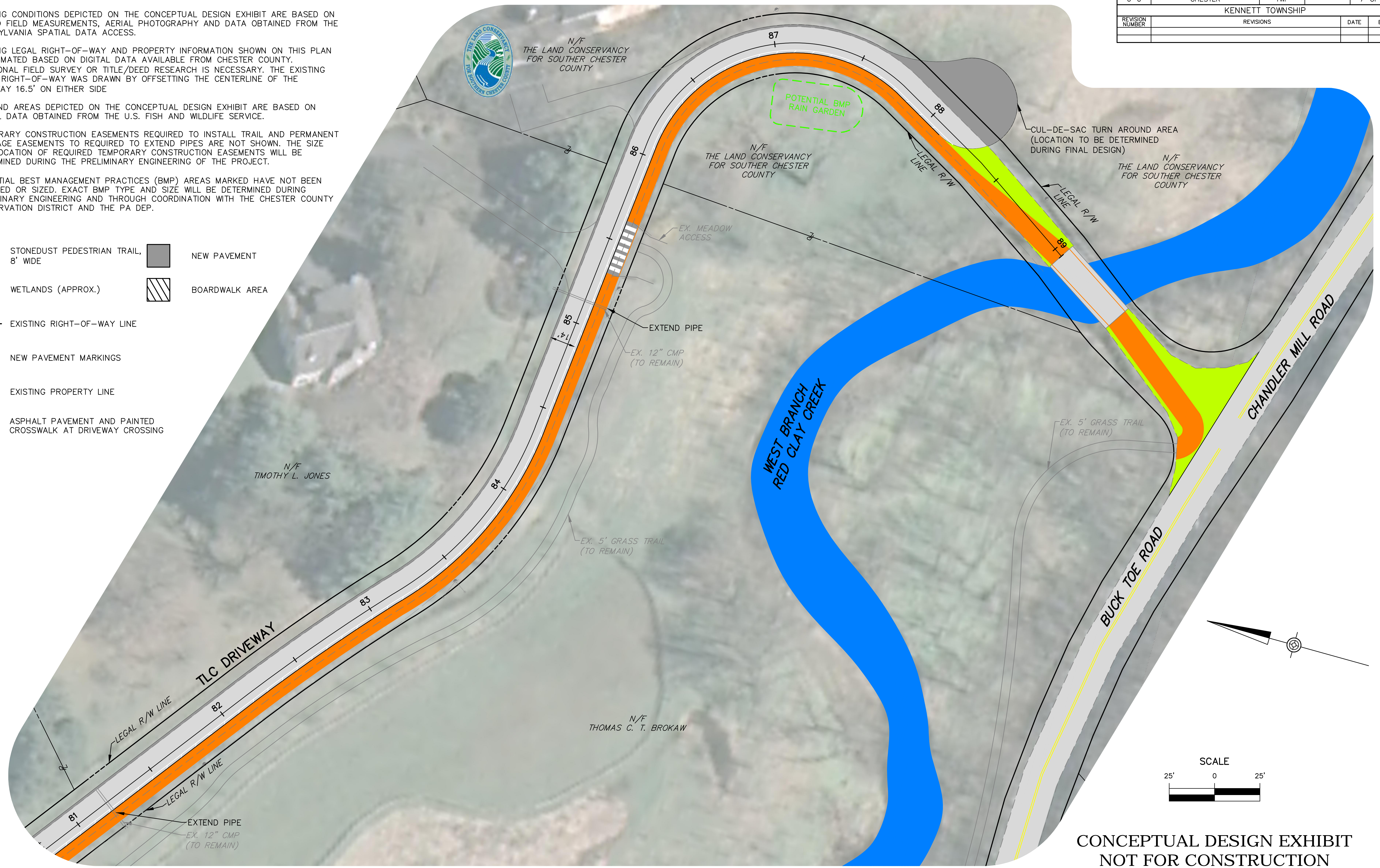

**CONCEPTUAL DESIGN EXHIBIT  
NOT FOR CONSTRUCTION**

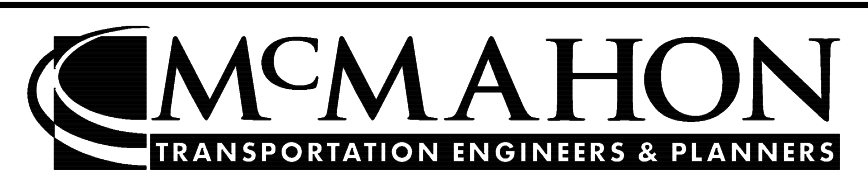

425 COMMERCE DR  
SUITE 200  
FT WASHINGTON, PA. 19034  
TELE: (215)-283-9444  
FAX: (215)-283-9447

840 SPRINGDALE DR  
EXTON, PA. 19341  
TELE: (610)-594-9995  
FAX: (610)-594-9565

3903 HARTZDALE DRIVE  
SUITE 301  
CAMP HILL, PA. 17011  
TELE: (717)-975-0295  
FAX: (717)-975-0294

DESIGN BY: KDK  
DRAWN BY: JCT  
CHECKED BY: JJK  
JOB NO: 815296  
DWG: 296CPT07  
DATE: 07/10/15

**KENNETT TOWNSHIP**  
841 BURROWS RUN ROAD  
CHADDS FORD, PA 19317  
(610)-388-1300

**RED CLAY GREENWAY TRAIL AND TRAFFIC CALMING IMPROVEMENTS ALONG CHANDLER MILL ROAD**  
KENNETT TOWNSHIP  
CHESTER COUNTY

DISTRICT	COUNTY	ROUTE	SECTION	SHEET
6-0	CHESTER	TWP	-	8 OF 8
KENNETT TOWNSHIP				
REVISION NUMBER	REVISIONS	DATE	BY	

CONCEPTUAL DESIGN EXHIBIT  
NOT FOR CONSTRUCTION

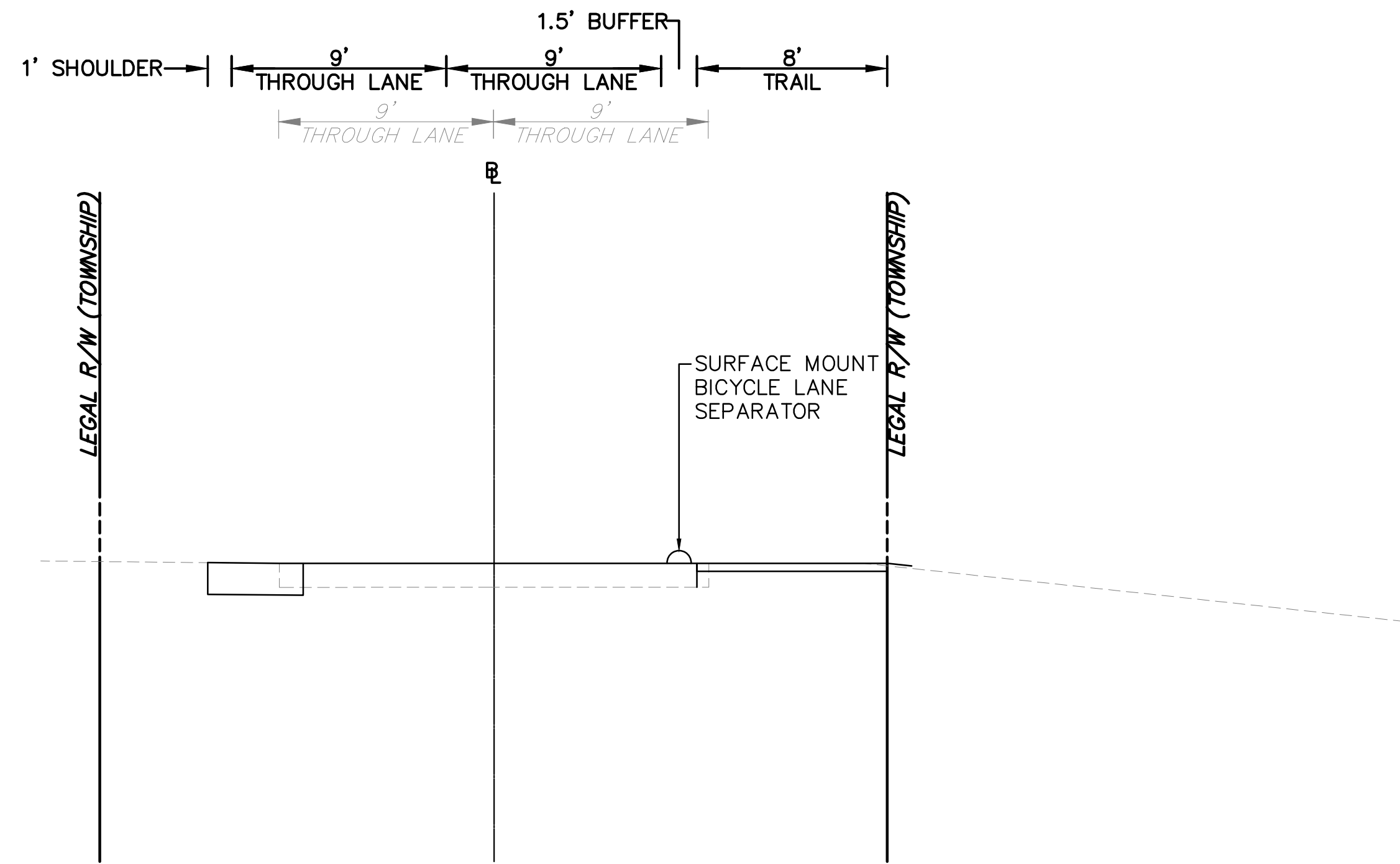

TYPICAL ROADWAY SECTION  
STATIONS VARY  
8' TRAIL

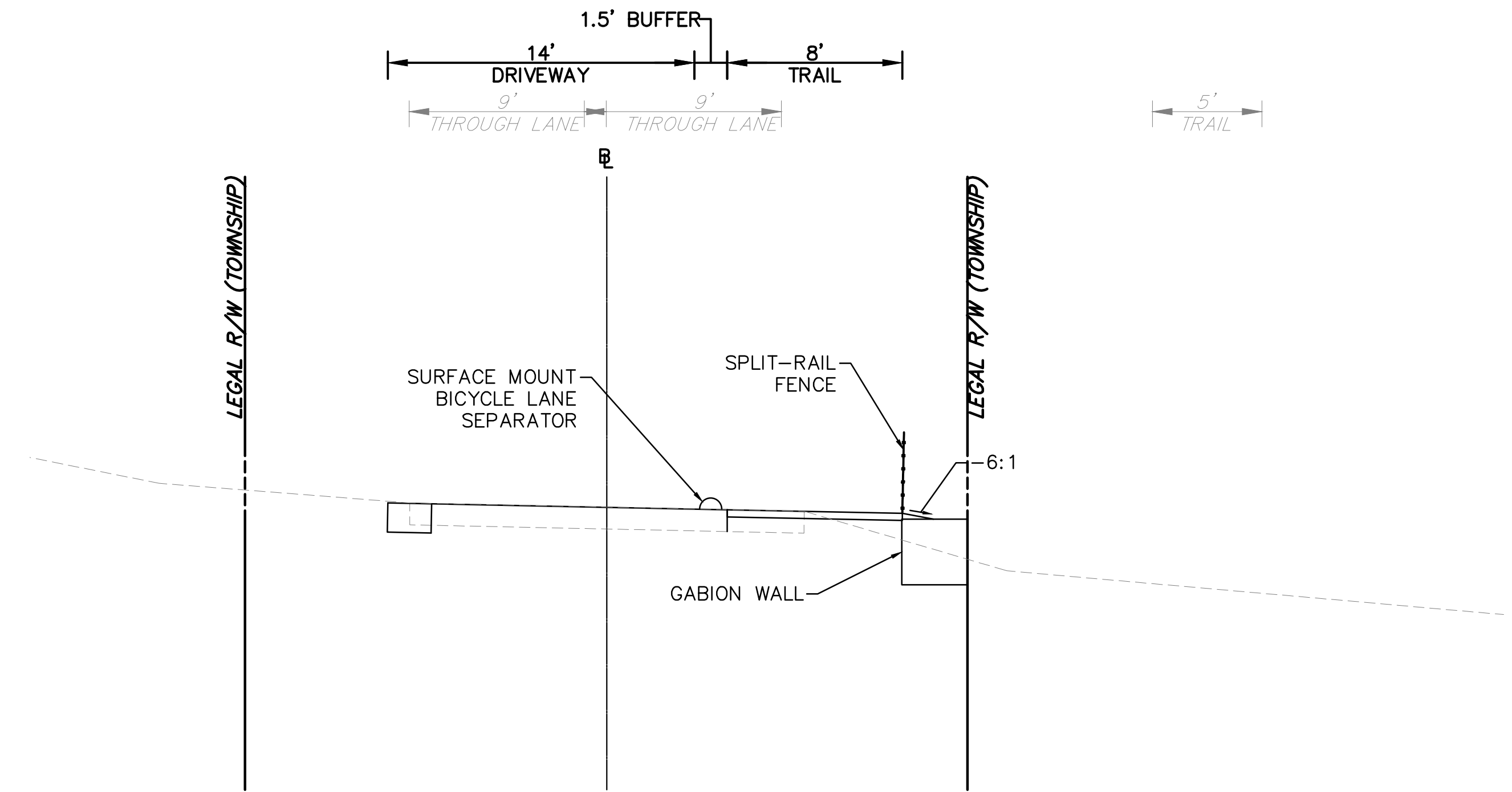

TYPICAL DRIVEWAY SECTION  
STA. 77+00 TO STA. 88+00  
8' TRAIL

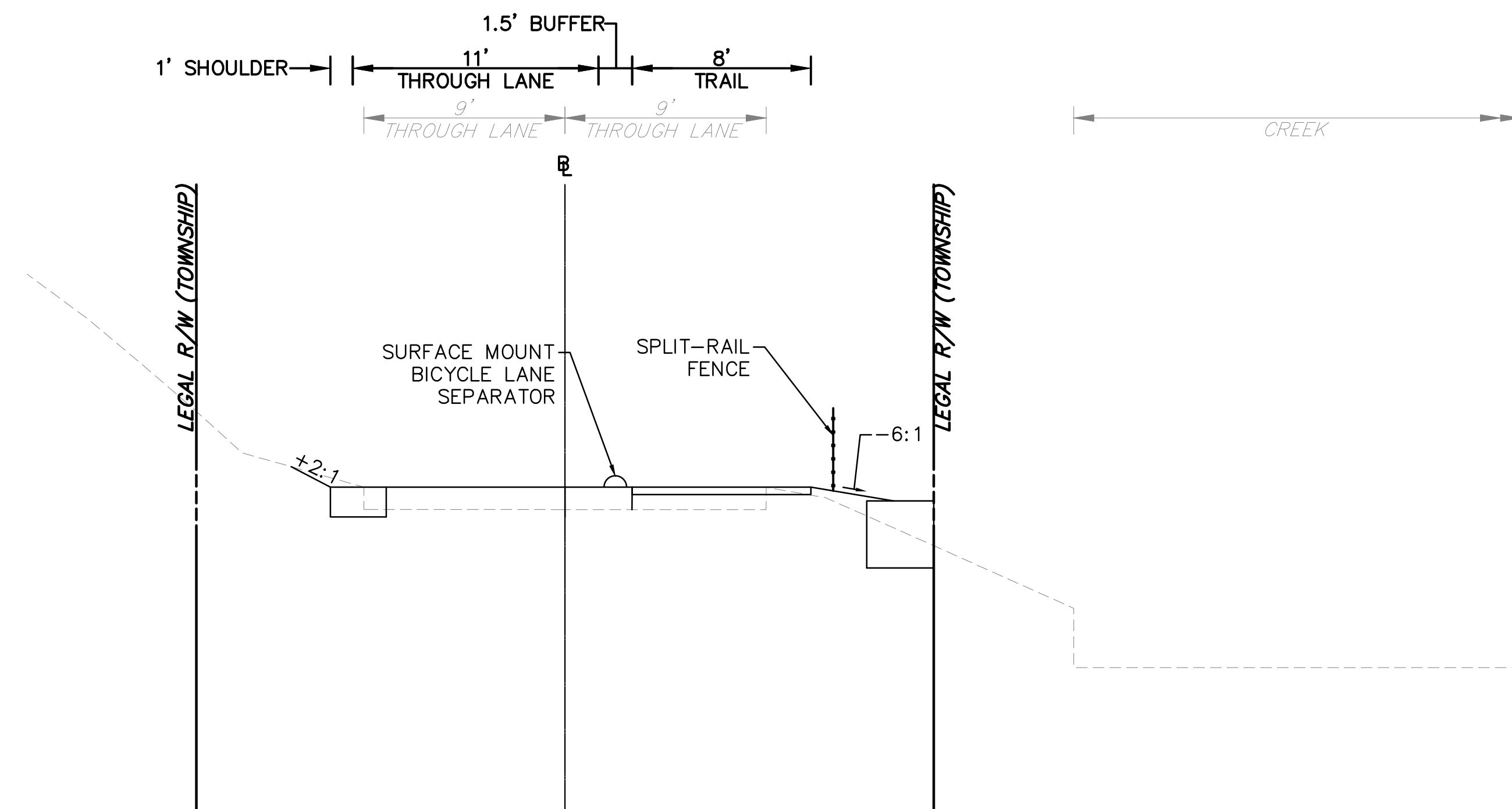

TYPICAL ONE-LANE CHOKER SECTION  
STA. 13+00 TO STA. 19+00  
8' TRAIL

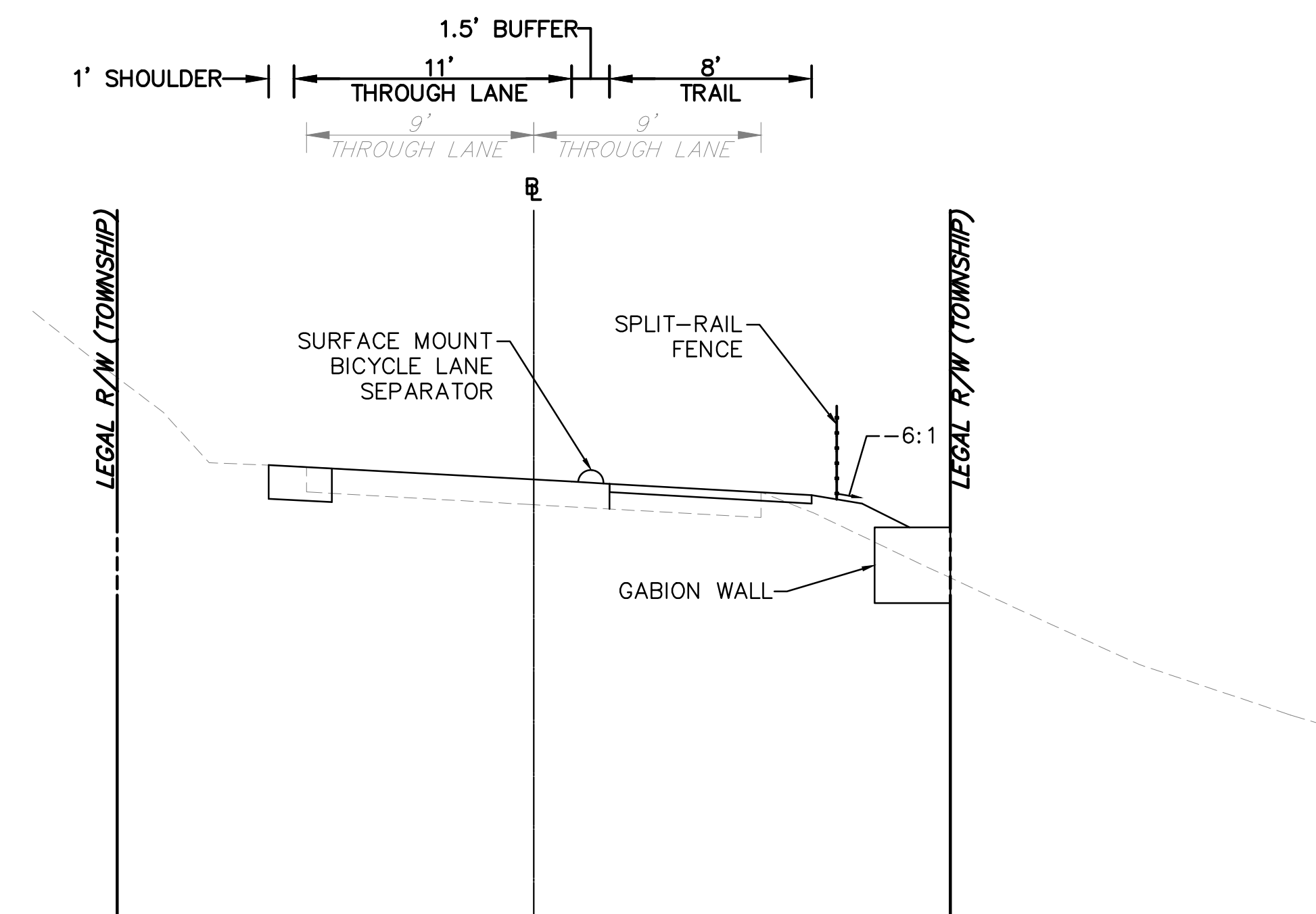

TYPICAL ONE-LANE CHOKER SECTION  
STA. 47+50 TO STA. 51+00  
8' TRAIL



425 COMMERCE DR  
SUITE 200  
FT WASHINGTON, PA. 19034  
TELE: (215)-283-9444  
FAX: (215)-283-9447

840 SPRINGDALE DR  
EXTON, PA. 19341  
TELE: (610)-594-9995  
FAX: (610)-594-9565

3903 HARTZDALE DRIVE  
SUITE 301  
CAMP HILL, PA. 17011  
TELE: (717)-975-0295  
FAX: (717)-975-0294

DESIGN BY: KDK  
DRAWN BY: JCT  
CHECKED BY: JJK  
JOB NO: 815296  
DWG:  
DATE: 07/10/15

KENNETT TOWNSHIP  
841 BURROWS RUN ROAD  
CHADDS FORD, PA 19317  
(610)-388-1300

RED CLAY GREENWAY TRAIL AND TRAFFIC CALMING  
IMPROVEMENTS ALONG CHANDLER MILL ROAD  
KENNETT TOWNSHIP  
CHESTER COUNTY